

# 2010 PLANNED PROJECTS

CITY OF GRAND FORKS,  
NORTH DAKOTA

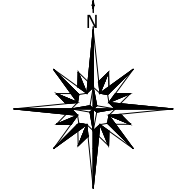

CITY ENGINEER: ALLEN R. GRASSER  
SCALE: NTS  
APRIL 2010

- KEY:**
- 1 PAVING (PROJECT NO. 6101.1)  
S. 48TH ST. FROM 16TH AVE. S. TO 32ND AVE. S.
  - 2 STORM SEWER AND DRAINAGE (PROJECT NO. 6101.4)  
S. 48TH ST. FROM 17TH AVE. S. TO 32ND AVE. S.
  - 3 LIFT STATION #32 REHAB (PROJECT NO. 6120)  
S. 48TH ST. AND 17TH AVE. S.
  - 4 REPLACE PUMP STATION #187 (PROJECT NO. 6144.1)  
32ND AVE. S. AND COLUMBIA RD.
  - 5 PAVING (PROJECT NO. 6272.2)  
CHERRY ST. FROM 17TH AVE. S. TO 25TH AVE. S.
  - 6 SIDEWALKS REPLACEMENT (PROJECT NO. 6323)  
17TH AVE. S. FROM S. WASHINGTON TO S. 16TH ST.
  - 7 PAVING AND LIGHTING (PROJECT NO. 6335)  
SHADYRIDGE BTH
  - 8 PAVEMENT REPLACEMENT (PROJECT NO. 6339)  
BUS GARAGE
  - 9 PAVING (PROJECT NO. 6405.2)  
CHERRY ST. FROM 25TH AVE. S. TO 47TH AVE. S.
  - 10 REPLACE ELECTRICAL UG (PROJECT NO. 6409.2)  
S. 5TH ST. NEAR POLICE DEPT. (WALNUT TO BRUCE)  
1ST AVE. S. FROM BRUCE TO 200' W OF COTTONWOOD  
AND RIDER ROAD
  - 11 PAVING (PROJECT NO. 6425.2)  
13TH AVE. S. FROM CHERRY ST. TO S. 20TH ST.
  - 12 PERMANENT LIFT STATION #37 (PROJECT NO. 6433)
  - 13 PAVING (PROJECT NO. 6480)  
30TH AVE. S. FROM S. 20TH ST. TO S. 25TH ST.
  - 14 RAILROAD CROSSING (PROJECT NO. 6473)  
ON S. 3RD ST. AND S. 4TH ST.
  - 15 SHARED USE BIKEPATH (PROJECT NO. 6476.2)  
S. 42ND ST. FROM 11TH AVE. S. TO 17TH AVE. S.
  - 16 PAVING (PROJECT NO. 6484)  
S. 18TH ST. RECONSTRUCTION FROM 24TH AVE. S. TO  
28TH AVE. S.
  - 17 PAVING (PROJECT NO. 6498)  
31ST AVE. S. FROM S. 20TH ST. TO S. 23RD ST.
  - 18 PAVING (PROJECT NO. 6499)  
S. 23RD ST. FROM 30TH AVE. S. TO 32ND AVE. S.
  - 19 WATERMAIN REPLACEMENT (PROJECT NO. 6520.1)  
STANFORD RD. FROM 6TH AVE. N. TO 11TH AVE. N.
  - 20 WATERMAIN REPLACEMENT (PROJECT NO. 6520.2)  
12TH AVE. N. FROM N. 17TH ST. TO N. 20TH ST.
  - 21 WATERMAIN REPLACEMENT (PROJECT NO. 6520.3)  
2400 BLOCK OF S. 10TH ST.
  - 22 WATERMAIN REPLACEMENT (PROJECT NO. 6520.4)  
STANFORD RD. FROM 11TH AVE. N. TO GATEWAY DR.
  - 23 WASHINGTON AND DEMERS LANDSCAPING  
(PROJECT NO. 6579)
  - 24 STREET LIGHTS (PROJECT NO. 6584)  
5TH AVE. N. FROM N. 53RD ST. TO N. 55TH ST.

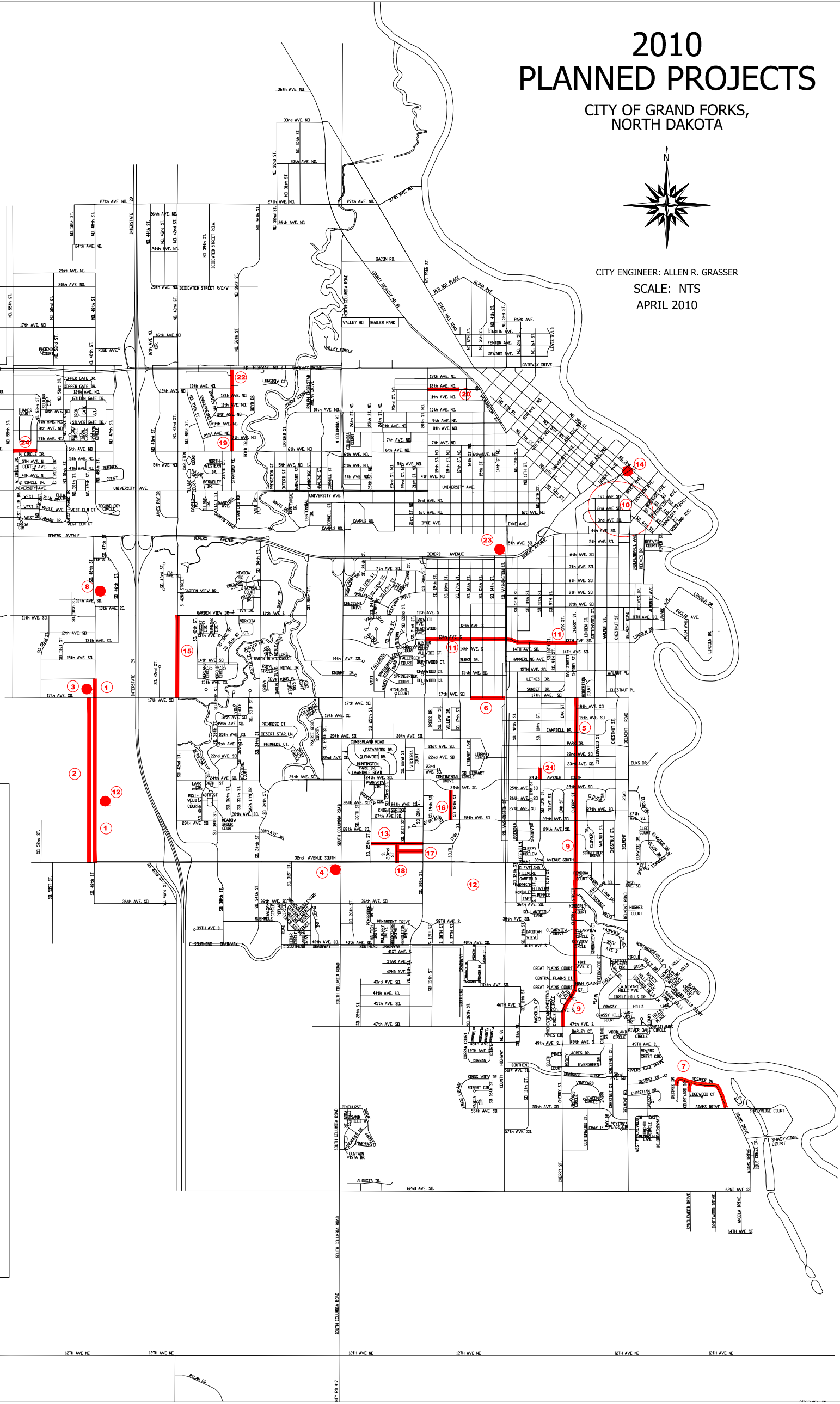

16TH AVE. NE 16TH AVE. NE 16TH AVE. NE 16TH AVE. NE 16TH AVE. NE 16TH AVE. NE